

Z73T

Z74T

1 1/4"-1 1/2" | DN25-DN40 | CLASS 150/300

Floating Ball Flanged Up to 538°C (1000°F)

Valve dimensions

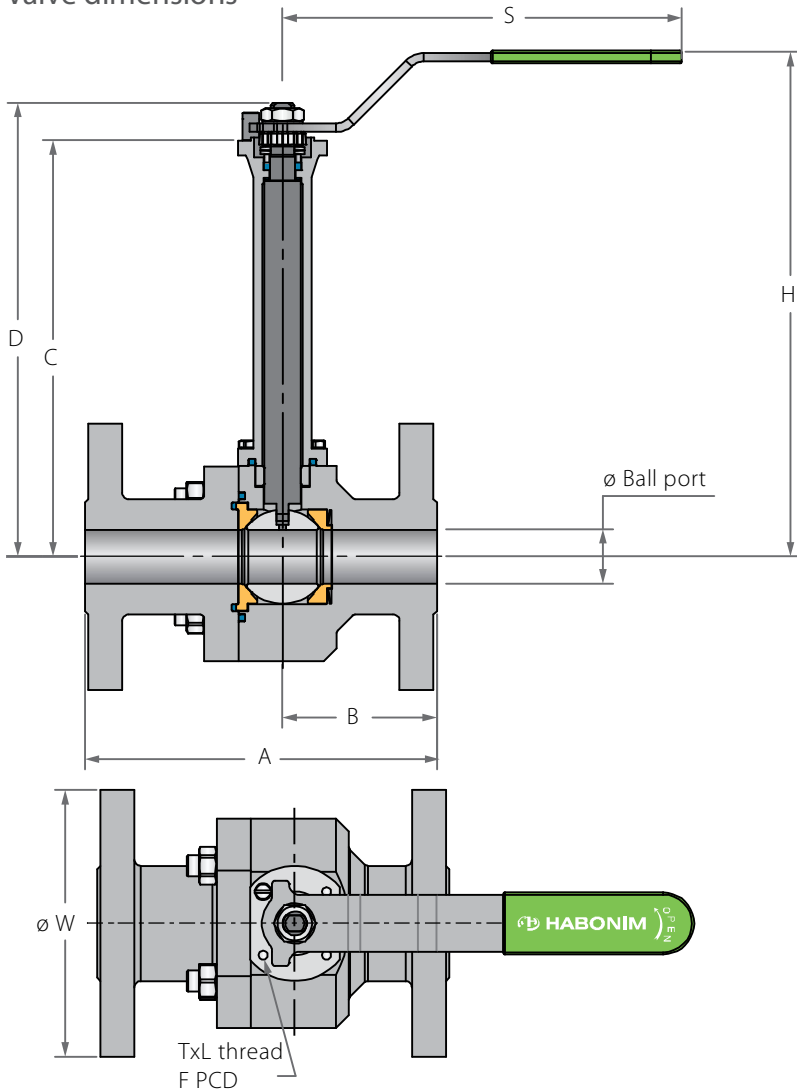

Preparation for actuation

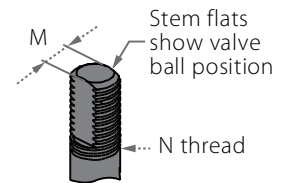
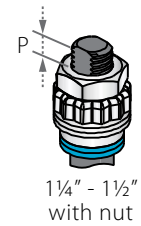

Std. port	Unit	Ball port	A		B		C	D	H	S	W		M	N	P	F	TxL	Weight kg/lb		Kv
			150	300	150	300					150	300						M	N	
DN32	mm	31.8	140	178	59	-	49.00	73	120.5	220.1	115	135	8.71	1/16" UNF	8.5 (F05)	50	M6x12	-	-	-
1 1/4"	inch	1.25	5.51	7.00	2.32	-	1.92	2.87	4.74	8.66	4.53	5.31	0.34	1/16" UNF	0.33	1.97	M6x12	-	-	-
DN40	mm	38.10	165.00	190.00	68.00	80.40	201.00	230.60	276.80	237.00	127.00	165.00	8.71	1/16" UNF	8.50 (F05)	50.00	M6x12	8.5	11.5	220
1 1/2"	inch	1.50	6.50	7.48	2.68	3.17	7.91	9.08	10.90	9.33	5.00	-	0.34	1/16" UNF	0.33	1.97	M6x12	18.7	25.3	255



Floating Ball Flanged Up to 538°C (1000°F)

Components & materials

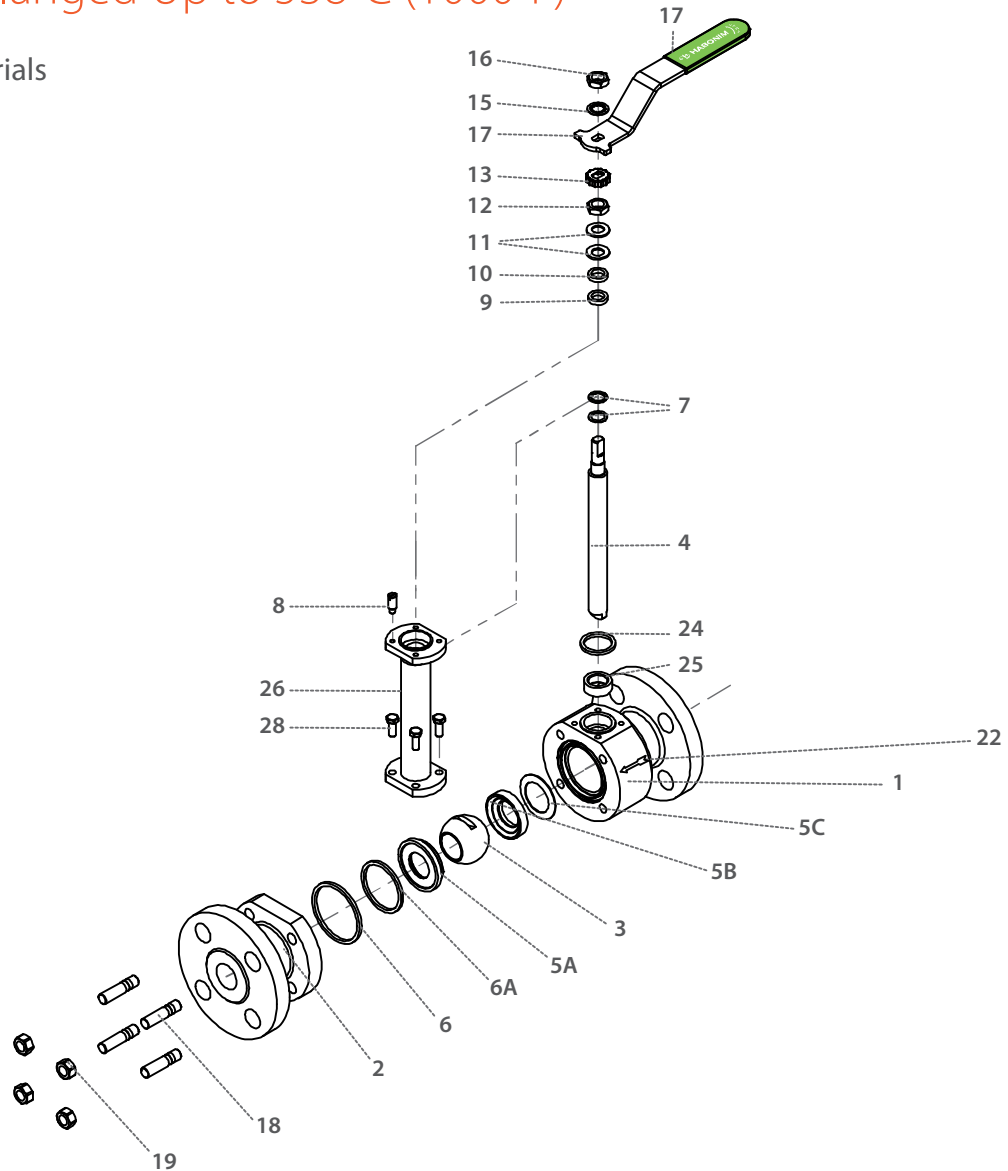

Item	Description	Material specification	Qty.
1	Body	Acc. Ordering Code	1
2	End	Acc. Ordering Code	1
3	Ball	Acc. Ordering Code	1
4	Stem	Acc. Ordering Code	1
5A	Downstream seat	Acc. Ordering Code	1
5B	Upstream seat	Acc. Ordering Code	1
5C	Upstream seat spring	Inconel 718	1
6*	Body seal	Graphite	2
6A*	Seat seal	Graphite	1
7*	Stem thrust seal	A479 316L, Hardened with LTPN, B637 N07718 Inconel 718	2
8	Stop pin	S. Steel	1
9*	Stem seal	Graphite	1
10	Follower	S. Steel	1
11	Disc spring	S. Steel	2

Item	Description	Material specification	Qty.
12	Stem nut	S. Steel	1
13	Locking clip	S. Steel	1
14	Handle	S. Steel	1
15	Serrated washer	S. Steel	1
16	Handle nut	S. Steel	1
17	Sleeve	PVC	1
18	Body bolts/studs	S. Steel	4
19	Body nuts	S. Steel	4
22		S. Steel	1
23	Tag (not shown)	S. Steel	1
24	Bonnet seal	Graphite	1
25	Stem Bearing	S. Steel	1
26	Bonnet	S. Steel	1
29	Bonnet bolts	S. Steel	4-6

* Repair kit components

Z73T

Z74T

2"-8" | DN50-DN200 | CLASS 150/300

Floating Ball Flanged Up to 538°C (1000°F)

Valve dimensions

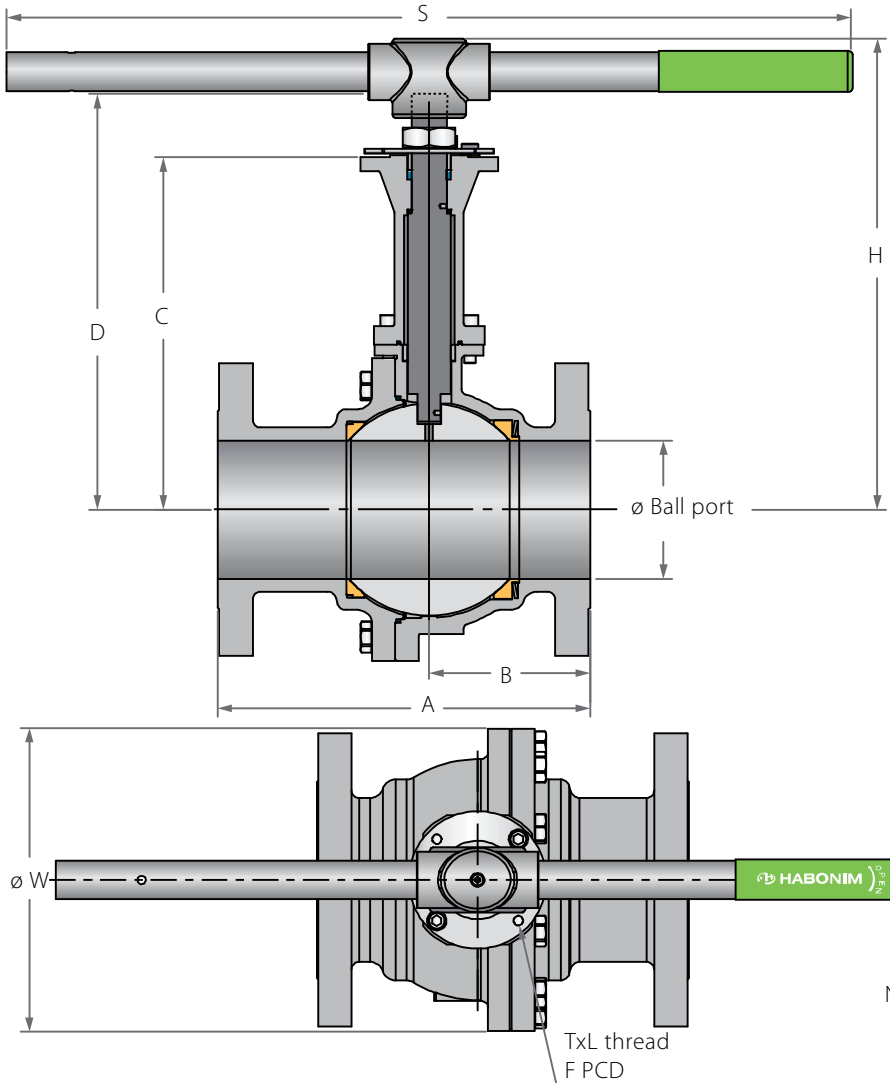

Preparation for actuation

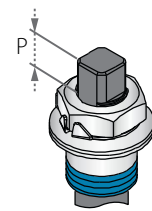

Stem groove shows valve ball position

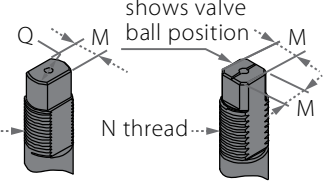

Std. port	Unit	Ball port	A		B		C	D	H	S	W		M	M DD	Q	N	P	F	TxL	Weight kg/lb		Kv
			150	300	150	300					150	300										
DN50	mm	51	178.00	216.00	69.00	75.10	222.80	264.40	290.00	256.00	127.00	127.00	-	13.90	20.00	M20x2.5	14.60 (F07)	70.00	M8x12	13.5	15.5	430
2"	inch	2.01	7.01	8.50	2.72	2.96	8.77	10.41	11.42	10.08	5.00	5.00	-	0.55	0.79	M20x2.5	0.57	2.76	M8x12	29.7	34.1	499
DN80	mm	80	203.00	282.50	77.50	96.40	260.40	307.00	347.20	401.00	190.50	210.00	18.90	15.90	22.70	1"-14 UNF-2A	16.70 (F10)	102.00	M10x20	25	32	1000
3"	inch	3.15	7.99	11.12	3.05	3.80	10.25	12.09	13.67	15.79	7.50	8.27	0.74	0.63	0.89	1"-14 UNF-2A	0.66	4.02	M10x20	55.0	70.4	1160
DN100	mm	100	228.50	304.80	84.50	104.50	276.40	323.00	-	-	230.00	254.00	18.90	15.90	22.70	1"-14 UNF-2A	16.70 (F10)	102.00	M10x20	45	50.0	1830
4"	inch	3.94	9.00	12.00	3.33	4.11	10.88	12.72	-	-	9.06	10.00	0.74	0.63	0.89	1"-14 UNF-2A	0.66	4.02	M10x20	99.0	110.0	2123
DN150	mm	150	394.00	403.50	163.50	174.50	382.20	451.70	-	-	328.00	328.00	28.45	23.75	35.20	1½"-12 UNF-2A	26.20 (F12)	125.00	M12x20	90	110	4380
6"	inch	5.91	15.51	15.89	6.44	6.87	15.05	17.78	-	-	12.91	12.91	1.12	0.94	1.39	1½"-12 UNF-2A	1.03	4.92	M12x20	198.0	242.0	5081
DN200	mm	200	457.20	501.65	242.50	240.70	495.50	608.20	-	-	343.00	381.00	35.92	35.92	46.50	2"-8 UN-2A	37.50 (F14)	140.00	M16x30	210	245	8070
8"	inch	7.87	18.00	19.75	9.55	9.48	19.51	23.94	-	-	13.50	15.00	1.41	1.41	1.83	2"-8 UN-2A	1.48	5.51	M16x30	462.0	539.0	9361



Floating Ball Flanged Up to 538°C (1000°F)

Components & materials

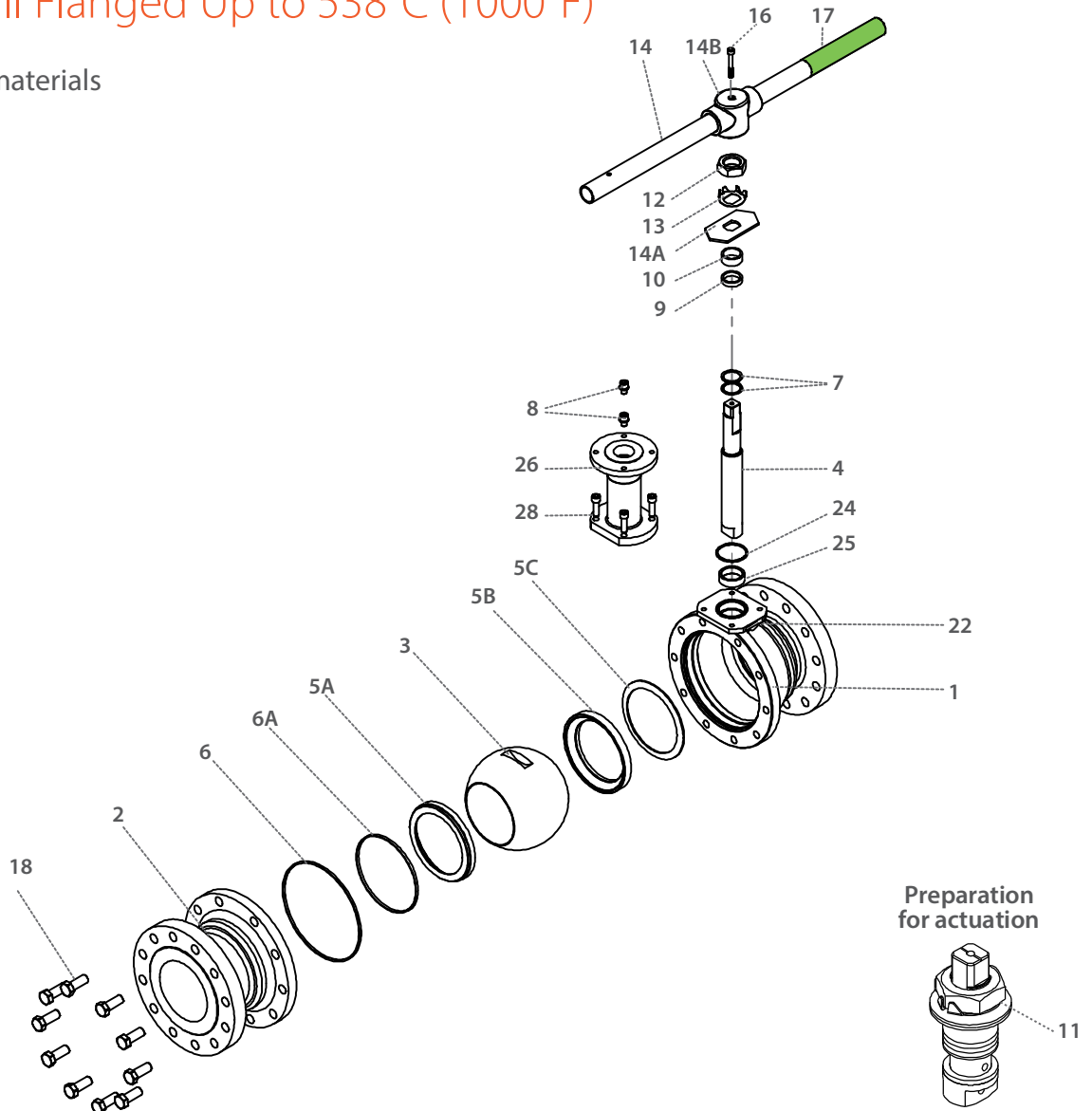

Item	Description	Material specification	Qty.
1	Body	Acc. Ordering Code	1
2	End	Acc. Ordering Code	1
3	Ball	Acc. Ordering Code	1
4	Stem	Acc. Ordering Code	1
5A	Downstream seat	Acc. Ordering Code	1
5B	Upstream seat	Acc. Ordering Code	1
5C	Upstream seat spring	Inconel 718	1
6*	Body seal	Graphite	2
6A*	Seat seal	Graphite	1
7*	Stem thrust seal	A479 316L, Hardened with LTPN, B637 N07718 Inconel 718	2
8	Stop pin	S. Steel	1
9*	Stem seal	Graphite	1
10	Follower	S. Steel	1
11	Disc spring	S. Steel	2
12	Stem nut	S. Steel	1

Item	Description	Material specification	Qty.
13	Tab lock washer	S. Steel	1
14**	Handle	S. Steel	1
14A	Stop plate	S. Steel	1
14B	Wrench head	S. Steel	1
16	Wrench bolt	S. Steel	1
17	Sleeve	PVC	1
18	Body bolts	S. Steel	8-12
22		S. Steel	1
23	Tag (not shown)	S. Steel	1
24	Bonnet seal	Graphite	1
25	Stem Bearing	S. Steel	1
26	Bonnet	S. Steel	1
28	Bonnet bolts	S. Steel	4-6

* Repair kit components

** Gear operator should be used for size 4" DN100 and above (handle components are not included)