

Z47W**Z47P****1/4"-2" | DN8-DN50 | CLASS 600**Floating Ball 3 Piece Up to **W** 260°C (500°F) | **P** 400°C (750°F)

Valve dimensions

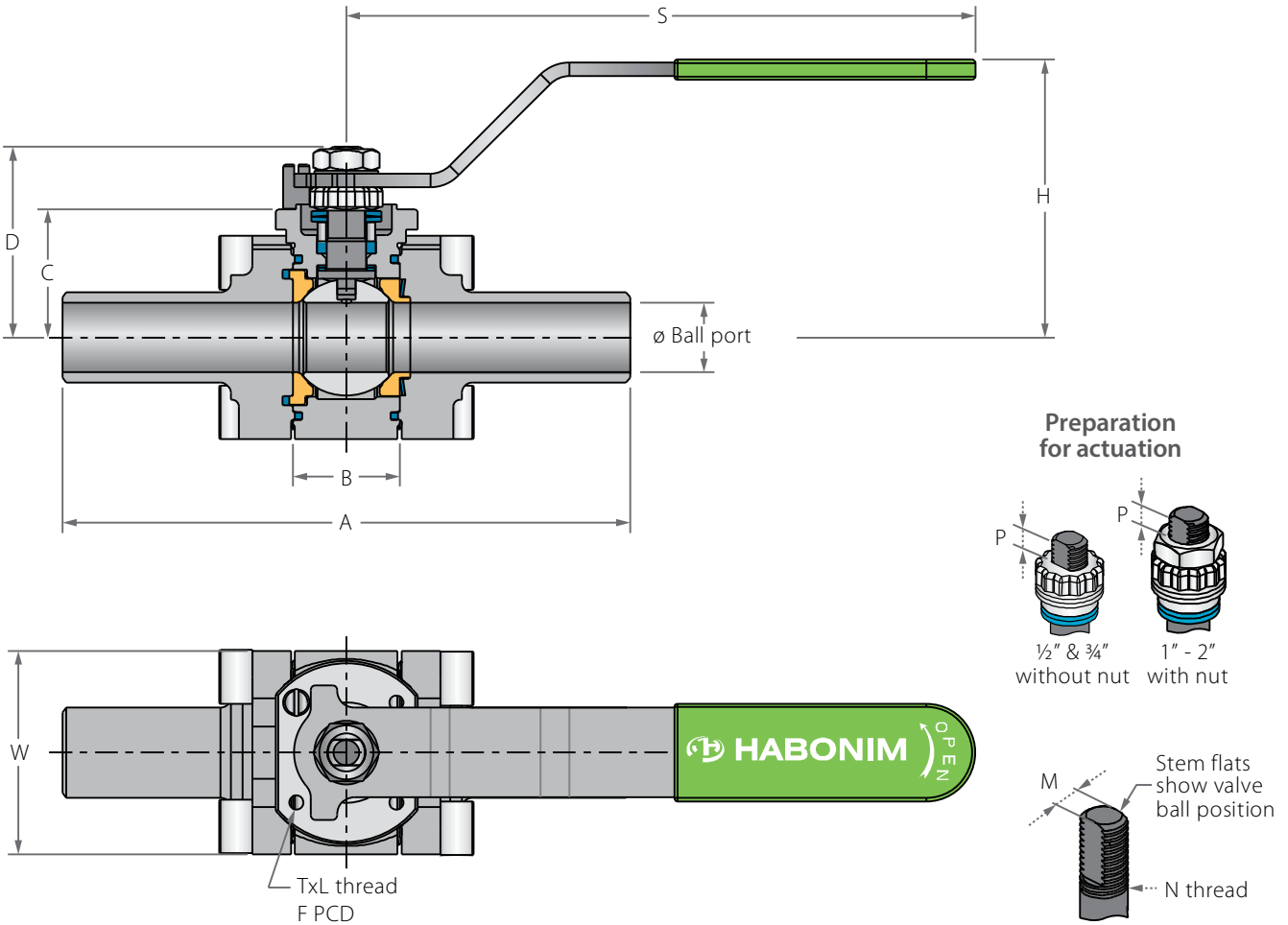

Valve Face To Face sizes are according to Habonim catalog data only, for Extended-weald/Flanged/Tri-clamp end see Face To Face sizes page.

Std. port	Full port	Unit	Ball port	A		B	C	D	H	S	W	M	N	P	F	TxL	Weight kg/lb	Kv Cv
				Welded	Threaded													
DN15	DN8, DN10	mm	11.15	140.60	66.00	20.60	29.00	37.90	62.00	150.00	46.00	5.54	1/2" UNF	6.65 (F03)	36.00	M5x10	1	6.9
1/2"	1/4", 3/8"	inch	0.44	5.54	2.60	0.81	1.14	1.49	2.44	5.91	1.81	0.22		0.26	1.42		2	8.0
DN20	DN15	mm	14.30	146.95	70.60	24.55	31.40	40.30	64.00	150.00	52.10	5.54	3/4" UNF	6.65 (F03)	36.00	M5x10	1	10
3/4"	1/2"	inch	0.56	5.79	2.78	0.97	1.24	1.59	2.52	5.91	2.05	0.22		0.26	1.42		2	12
DN25	DN20	mm	20.65	168.75	94.00	31.75	38.15	55.50	80.00	187.00	60.50	7.54	1/2" UNF	7.40 (F04)	42.00	M5x10	2	28
1"	3/4"	inch	0.81	6.64	3.70	1.25	1.50	2.19	3.15	7.36	2.38	0.30		0.29	1.65		4	32
DN32	DN25	mm	25.50	179.25	108.50	41.25	42.65	60.50	84.50	187.00	69.00	7.54	1/2" UNF	7.40 (F04)	42.00	M5x10	3	49
1 1/4"	1"	inch	1.00	7.06	4.27	1.62	1.68	2.38	3.33	7.36	2.72	0.30		0.29	1.65		6	57
DN40	DN32	mm	31.80	189.40	116.00	48.40	43.50	73.00	96.00	237.00	79.20	8.71	1/2" UNF	8.50 (F05)	50.00	M6x12	3	69
1 1/2"	1 1/4"	inch	1.25	7.46	4.57	1.91	1.71	2.87	3.78	9.33	3.12	0.34		0.33	1.97		8	80
DN50	DN40	mm	38.10	200.30	128.00	56.30	48.20	77.70	100.00	237.00	90.70	8.71	1/2" UNF	8.50 (F05)	50.00	M6x12	5	102
2"	1 1/2"	inch	1.50	7.89	5.04	2.22	1.90	3.06	3.94	9.33	3.57	0.34		0.33	1.97		11	208

Z47W**Z47P****1/4"-2" | DN8-DN50 | CLASS 600**

Floating Ball 3 Piece Up to **W** 260°C (500°F) | **P** 400°C (750°F)

Components & materials

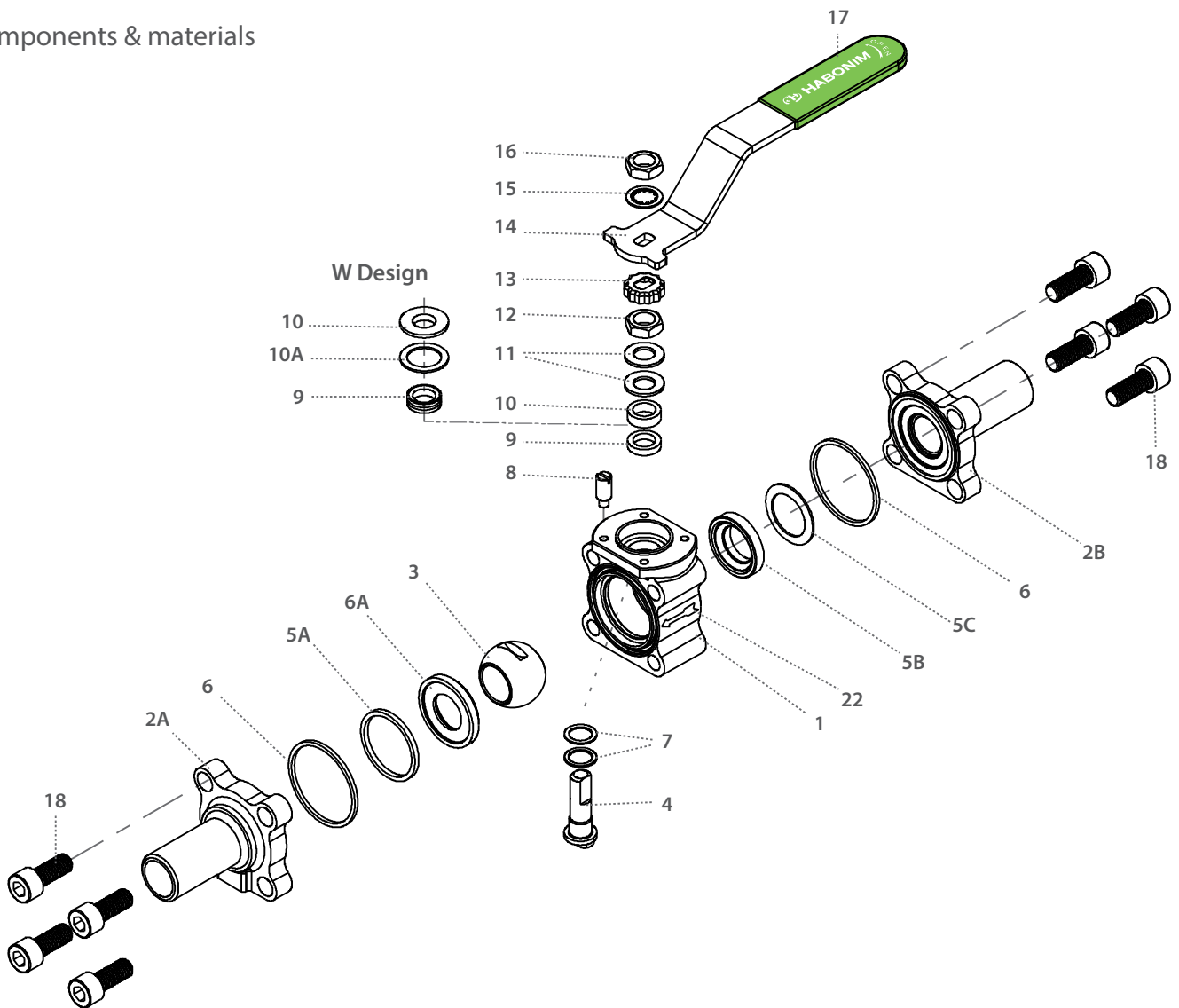

Item	Description	Material specification	Qty.
1	Body	Acc. Ordering Code	1
2A	Downstream end	Acc. Ordering Code	1
2B	Upstream end	Acc. Ordering Code	1
3	Ball	Acc. Ordering Code	1
4	Stem	Acc. Ordering Code	1
5A	Downstream seat	Acc. Ordering Code	1
5B	Upstream seat	Acc. Ordering Code	1
5C	Upstream disc spring	Inconel 718	1
6*	Body seal	Graphite	2
6A*	Seat seal	Graphite	1
7*	Stem thrust seal	A479 316L Hardened with LTPN, B637 N07718 Inconel 718, Virgin peek, PCTFE	2
8	Stop pin	S. Steel	1

Item	Description	Material specification	Qty.
9*	Stem seal	Graphite ,CF PTFE, TFM	1
10	Follower	S. Steel	1
10A*	Slide Bearing	S. Steel	1
11	Disc spring	S. Steel	2
12	Stem nut	S. Steel	1
13	Locking clip	S. Steel	1
14	Handle	S. Steel	1
15	Serrated washer	S. Steel	1
16	Handle nut	S. Steel	1
17	Sleeve	PVC	1
18	Body bolts	S. Steel	8
22	Arrow flow	S. Steel	1
23	Tag (not shown)	S. Steel	1

* Repair kit components

Z47W**Z47P**

2½"-8" | DN65-DN200 | CLASS 600

Floating Ball 3 Piece Up to **W** 260°C (500°F) | **P** 400°C (750°F)

Valve dimensions

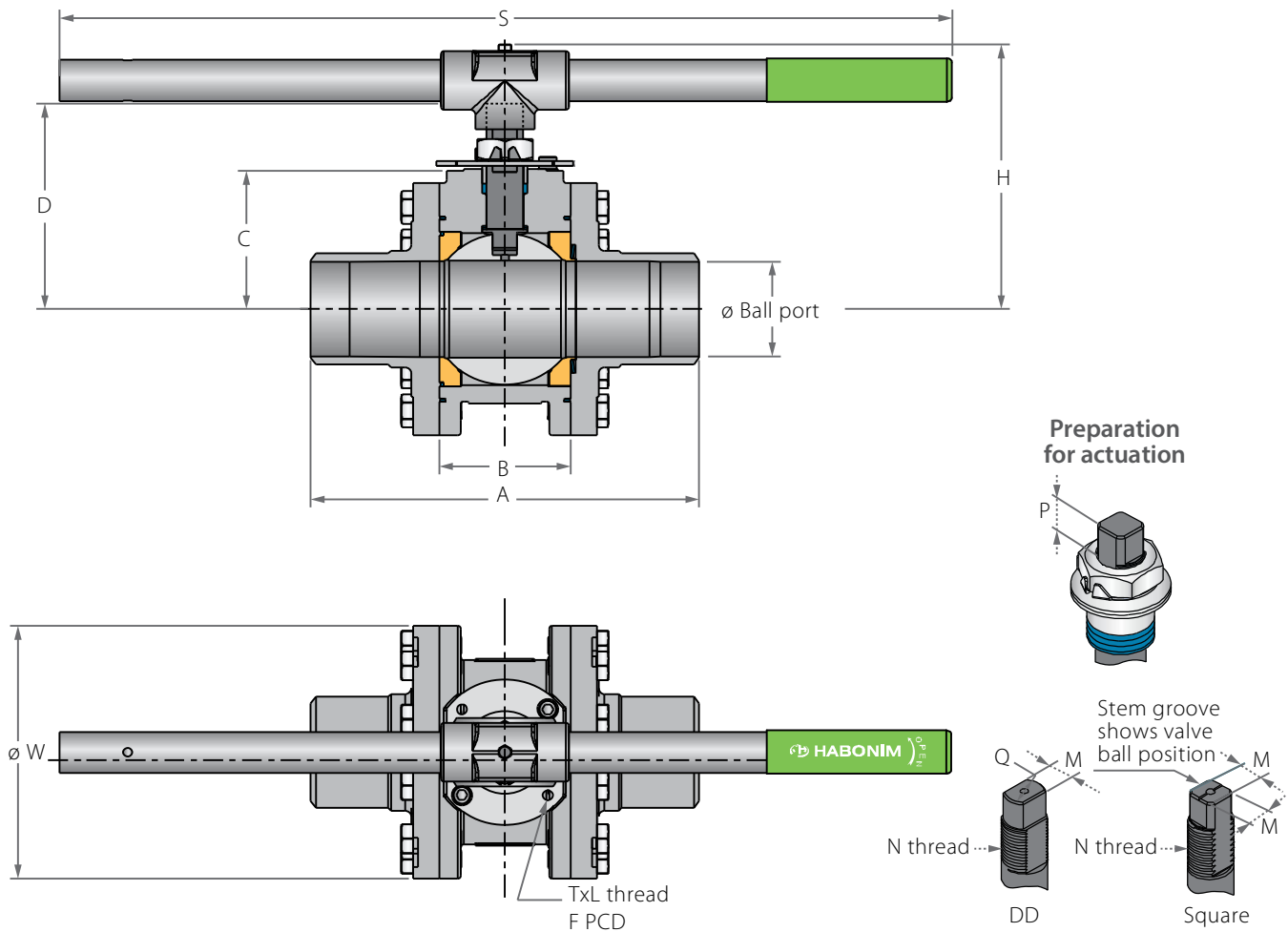

Valve Face To Face sizes are according to Habonim catalog data only, for Extended-weald/Flanged/Tri-clamp end see Face To Face sizes page.

Std. port	Full port	Unit	Ball port	A		B	C	D	H	S	W	M	M (DD)	Q	N	P	F	TxL	Weight kg/lb	Kv Cv	
				Welded	Threaded																
DN65	DN50	mm	51.00	200.00	160.00	75.00	87.50	134.00	174.00	401.00	150.00	18.90	15.90	22.70	1"-14	16.70	(F10)	102.00	M10x20	14.20	430
2½"	2"	inch	2.01	7.87	6.30	2.95	3.44	5.28	6.85	15.79	5.91	0.74	0.63	0.89	UNF-2A	0.66	4.02			31.24	499
DN80	DN65	mm	63.75	285.00	213.00	108.80	114.10	160.60	201.00	600.00	191.50	18.90	15.90	22.70	1"-14	16.70	(F10)	102.00	M10x20	25.00	1000
3"	2½"	inch	2.51	11.22	8.39	4.28	4.49	6.32	7.91	23.62	7.54	0.74	0.63	0.89	UNF-2A	0.66	4.02			55.00	1160
DN100	DN80	mm	80.00	356.00	-	110.00	126.50	195.90	256.6	916.00	210.00	28.45	23.75	35.20	1½"-12	26.20	(F12)	125.00	M12x20	38.00	1830
4"	3"	inch	3.15	14.02	-	4.33	4.98	7.71	10.10	36.06	8.27	1.12	0.94	1.39	UNF-2A	1.03	4.92			83.60	2123
DN150	DN100	mm	100.00	395.00	-	135.00	142.40	211.9	-	-	260.00	28.45	23.75	35.20	1½"-12	26.20	(F12)	125.00	M12x20	60.00	4380
6"	4"	inch	3.94	15.55	-	5.31	5.61	8.34	-	-	10.24	1.12	0.94	1.39	UNF-2A	1.03	4.92			132.00	5081
DN200	DN150	mm	150.00	490.00	-	190.00	194.00	307	-	-	360.00	35.92	35.92	46.50	2"-8	40.00	(F14)	140.00	M16x20	130.00	8070
8"	6"	inch	5.91	19.29	-	7.48	7.64	12.09	-	-	14.17	1.41	1.41	1.83	UN-2A	1.57	5.51			286.00	9361
	DN200	mm	200.00	500.00	-	275.00	245.00	400	-	-	470.00	45.90	45.90	55.00	2¾"-8	50.00	(F16)	165.00	M20x30	315.00	7600
	8"	inch	7.87	19.69	-	10.83	9.65	15.75	-	-	18.50	1.81	1.81	2.17	UN-2A	1.97	6.50			693.00	6590

Z47W**Z47P**

2½"-8" | DN65-DN200 | CLASS 600

 Floating Ball 3 Piece Up to **W** 260°C (500°F) | **P** 400°C (750°F)

Components & materials

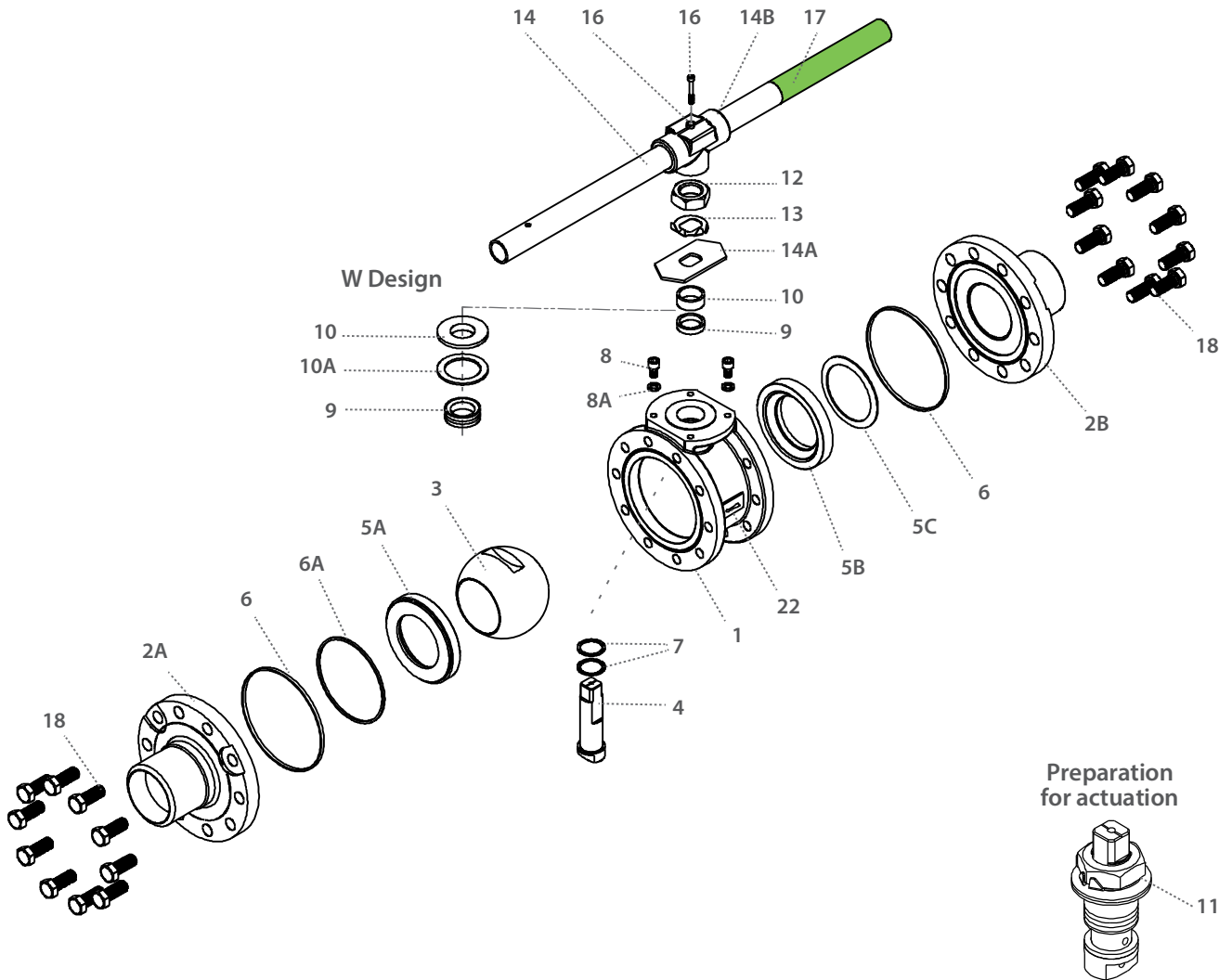

Item	Description	Material specification	Qty.
1	Body	Acc. Ordering Code	1
2A	Downstream end	Acc. Ordering Code	1
2B	Upstream end	Acc. Ordering Code	1
3	Ball	Acc. Ordering Code	1
4	Stem	Acc. Ordering Code	1
5A	Downstream seat	Acc. Ordering Code	1
5B	Upstream seat	Acc. Ordering Code	1
5C	Upstream disc spring	Inconel 718	1
6*	Body seal	Graphite	2
6A*	Seat seal	Graphite	1
7*	Stem thrust seal	A479 316L Hardened with LTPN, B637 N07718 Inconel 718, Virgin peek, PCTFE	2
8	Stop pin	S. Steel	1
9*	Stem seal	Graphite, CF PTFE, TFM	1
10A*	Slide Bearing	S. Steel	1

Item	Description	Material specification	Qty.
10	Follower	S. Steel	1
11	Disc spring	S. Steel	2
12	Stem nut	S. Steel	1
13	Tab lock washer	S. Steel	1
14**	Handle	S. Steel	1
14A	Stop plate	S. Steel	1
14B	Wrench head	S. Steel	1
16	Wrench bolt	S. Steel	1
17	Sleeve	PVC	1
18	Body bolts	S. Steel	20-32
22		S. Steel	1
23	Tag (not shown)	S. Steel	1

* Repair kit components

** Gear operator should be used for size 6" DN150 and above (handle components are not included)