

**Z47T****Z47M**

1/4"-2" | DN8-DN50 | CLASS 600

Floating Ball 3 Piece Up to **T** 538°C (1000°F) | **M** 650°C (1200°F)

## Valve dimensions

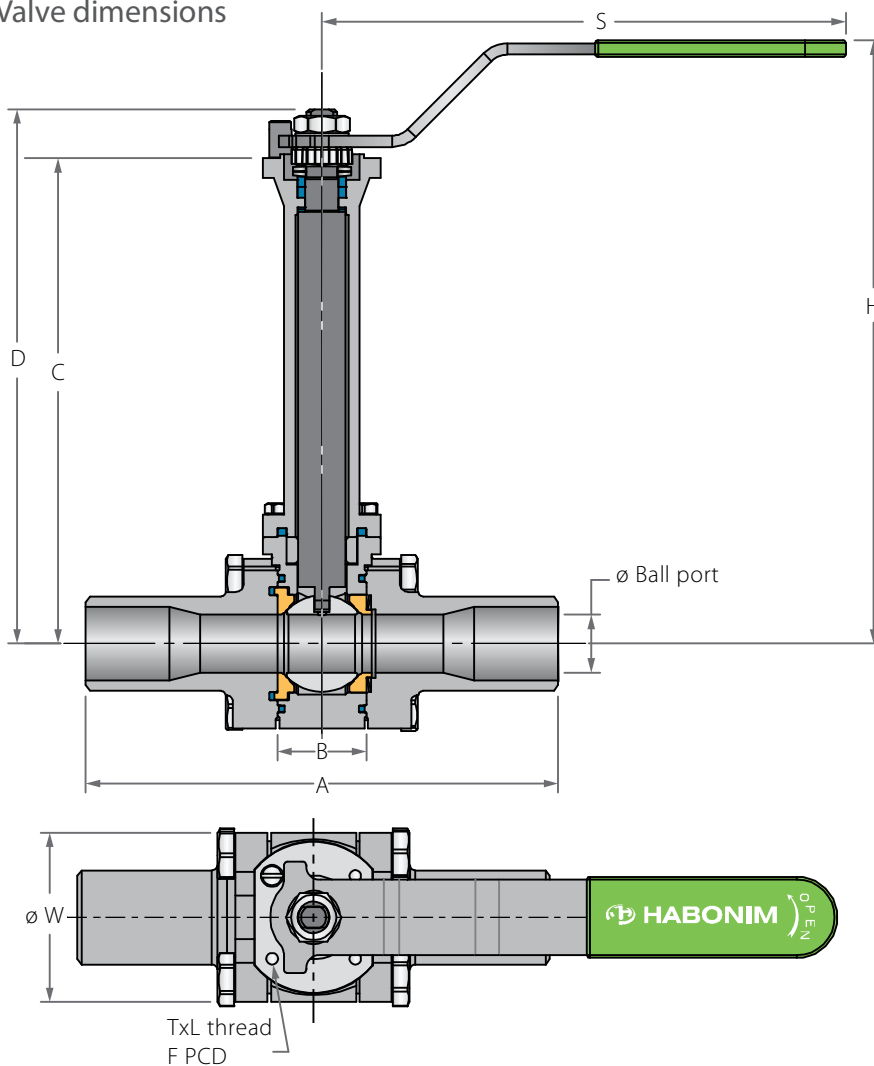

## Preparation for actuation

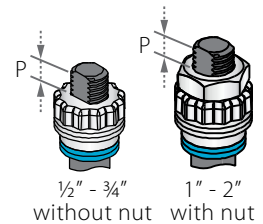
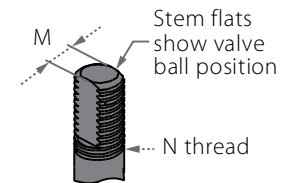
1/2" - 3/4" without nut  
1" - 2" with nut

Valve Face To Face sizes are according to Habonim catalog data only, for Extended-weald/Flanged/Tri-clamp end see Face To Face sizes page.

Std. port	Full port	Unit	Ball port	A		B	C	D	H	S	W	M	N	P	F	W	TxL	Weight kg/lb	Kv Cv
				Welded	Threaded														
DN15	DN8, DN10	mm	11.15	140.60	66.00	20.60	181.40	190.30	214.40	150.00	46.00	5.54	3/8" UNF	6.65	(F03)	36.00	M5x10	1.35	6.9
1/2"	1/4", 3/8"	inch	0.44	5.54	2.60	0.81	7.14	7.49	8.44	5.91	1.81	0.22		0.26		1.42		2.97	8.0
DN20	DN15	mm	14.30	146.95	70.60	24.55	183.40	192.30	216.40	150.00	52.10	5.54	3/8" UNF	6.65	(F03)	36.00	M5x10	1.55	10
3/4"	1/2"	inch	0.56	5.79	2.78	0.97	7.22	7.57	8.52	5.91	2.05	0.22		0.26		1.42		3.41	12
DN25	DN20	mm	20.65	168.75	94.00	31.75	190.40	207.90	231.40	230.00	60.50	7.54	1/2" UNF	7.40	(F04)	42.00	M5x10	2.85	28
1"	3/4"	inch	0.81	6.64	3.70	1.25	7.50	8.19	9.11	9.06	2.38	0.30		0.29		1.65		6.27	32
DN32	DN25	mm	25.50	179.25	108.50	41.25	195.40	212.90	236.40	230.00	69.00	7.54	1/2" UNF	7.40	(F04)	42.00	M5x10	3.55	49
1 1/4"	1"	inch	1.00	7.06	4.27	1.62	7.69	8.38	9.31	9.06	2.72	0.30		0.29		1.65		7.81	57
DN40	DN32	mm	31.80	189.40	116.00	48.40	195.40	224.90	248.40	237.00	79.20	8.71	1/2" UNF	8.50	(F05)	50.00	M6x12	4.50	69
1 1/2"	1 1/4"	inch	1.25	7.46	4.57	1.91	7.69	8.85	9.78	9.33	3.12	0.34		0.33		1.97		9.90	80
DN50	DN40	mm	38.10	200.30	128.00	56.30	200.40	229.90	253.40	237.00	90.70	8.71	1/2" UNF	8.50	(F05)	50.00	M6x12	6.00	102
2"	1 1/2"	inch	1.50	7.89	5.04	2.22	7.89	9.05	9.98	9.33	3.57	0.34		0.33		1.97		13.20	118

Z47T

Z47M

1/4"-2" | DN8-DN50 | CLASS 600



Floating Ball 3 Piece Up to **T** 538°C (1000°F) | **M** 650°C (1200°F)

### Components & materials

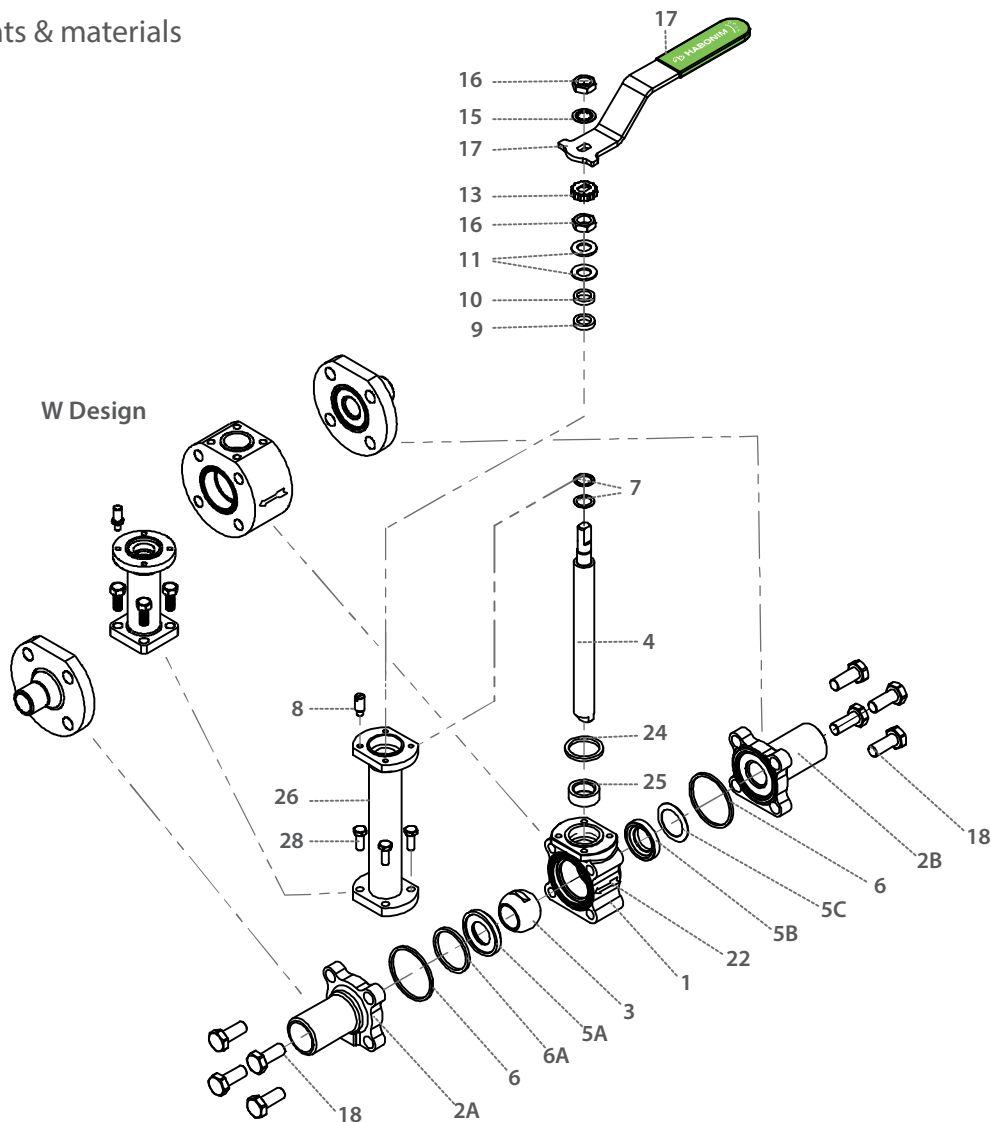

Item	Description	Material specification	Qty.
1	Body	Acc. Ordering Code	1
2A	Downstream end	Acc. Ordering Code	1
2B	Upstream end	Acc. Ordering Code	1
3	Ball	Acc. Ordering Code	1
4	Stem	Acc. Ordering Code	1
5A	Downstream seat	Acc. Ordering Code	1
5B	Upstream seat	Acc. Ordering Code	1
5C	Upstream seat spring	Inconel 718	1
6*	Body seal	Graphite	2
6A*	Seat seal	Graphite	1
7*	Stem thrust seal	A479 316L, Hardened with LTPN, B637 N07718 Inconel 718	2
8	Stop pin	S. Steel	1
9*	Stem seal	Graphite	1
10	Follower	S. Steel	1

Item	Description	Material specification	Qty.
11	Disc spring	S. Steel	2
12	Stem nut	S. Steel	1
13	Locking clip	S. Steel	1
14	Handle	S. Steel	1
15	Serrated washer	S. Steel	1
16	Handle nut	S. Steel	1
17	Sleeve	PVC	1
18	Body bolts	S. Steel	8
22		S. Steel	1
23	Tag (not shown)	S. Steel	1
24	Bonnet seal	Graphite	1
25	Stem Bearing	S. Steel	1
26	Bonnet	S. Steel	1
28	Bonnet bolts	S. Steel	4

\* Repair kit components

**Z47T****Z47M**

2½"-8" | DN65-DN200 | CLASS 600

Floating Ball 3 Piece Up to **T** 538°C (1000°F) | **M** 650°C (1200°F)

## Valve dimensions

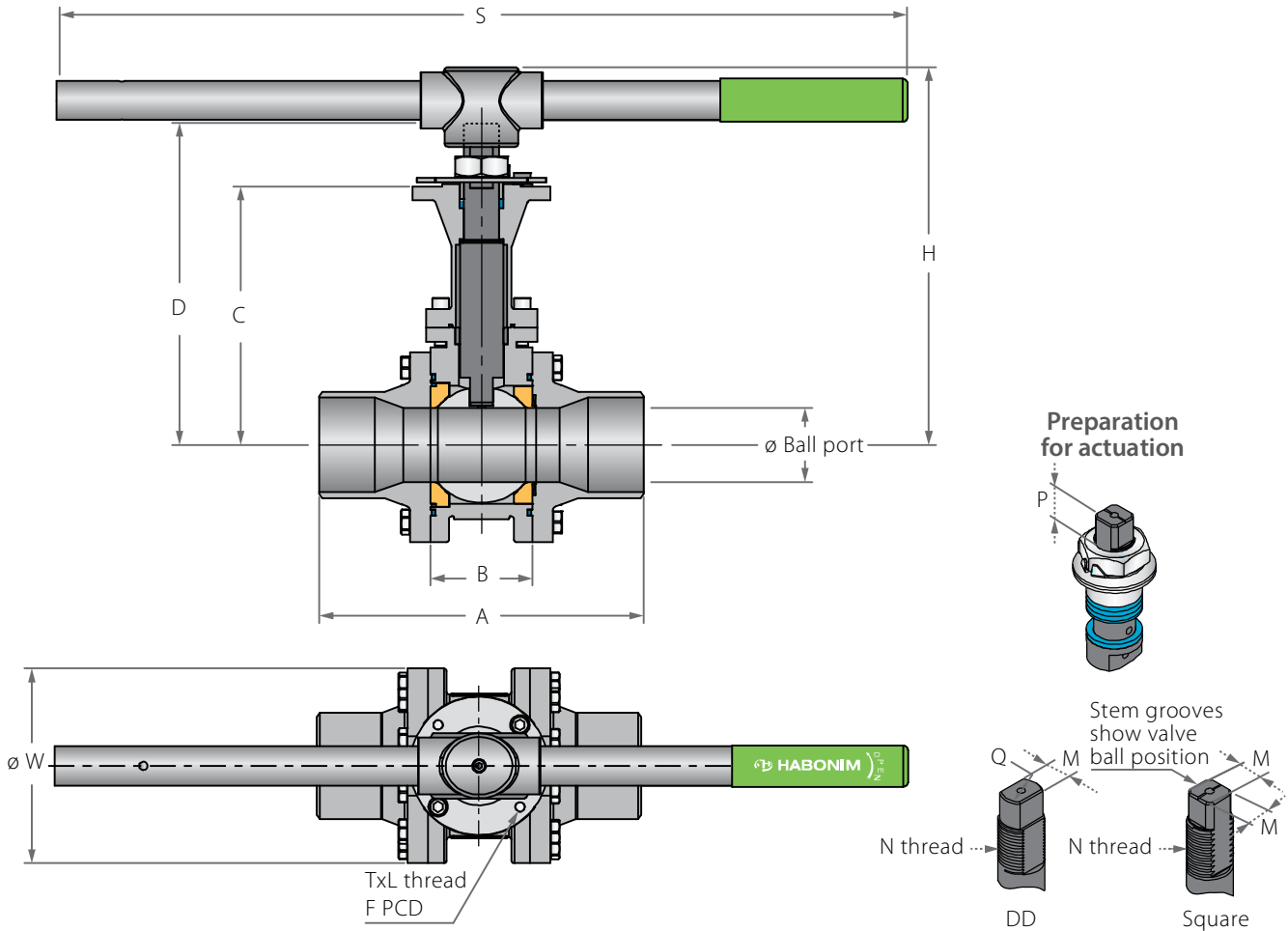

Valve Face To Face sizes are according to Habonim catalog data only, for Extended-weald/Flanged/Tri-clamp end see Face To Face sizes page.

Std. port	Full port	Unit	Ball port	A		B	C	D	H	S	W	M	M (DD)	Q	N	P	F	TxL	Weight kg/lb	Kv
				Welded	Threaded															Cv
DN65	DN50	mm	51	200	160.00	75	239.90	286.40	326.40	401	150	18.90	15.90	22.70	1"-14	16.70 (F10)	102.00	M10x20	19.2	208
2½"	2"	inch	2.01	7.87	6.30	2.95	9.44	11.28	12.85	15.79	5.91	0.74	0.63	0.89	UNS-2A	0.66	4.02	M10x20	42.2	241
DN80	DN65	mm	63.75	285.00	213.00	108.80	266.50	313.00	353.50	600.00	191.50	18.90	15.90	22.70	1"-14	16.70 (F10)	102.00	M10x20	30.0	300
3"	2½"	inch	2.51	11.22	8.39	4.28	10.49	12.32	13.92	23.62	7.54	0.74	0.63	0.89	UNS-2A	0.66	4.02	M10x20	66.0	348
DN100	DN80	mm	80	356	-	110	278.90	348.00	-	-	210	28.45	23.75	35.20	1½"-12	26.20 (F12)	125.00	M12X20	46.0	615
4"	3"	inch	3.15	14.02	-	4.33	10.98	13.70	-	-	8.27	1.12	0.94	1.39	UNF-2A	1.03	4.92	M12X20	101.2	713
DN150	DN100	mm	100	400.00	-	135	294.80	364.00	-	-	260	28.45	23.75	35.20	1½"-12	26.20 (F12)	125.00	M12X20	68.0	872
6"	4"	inch	3.94	15.75	-	5.31	11.61	14.33	-	-	10.24	1.12	0.94	1.39	UNF-2A	1.03	4.92	M12X20	149.6	1012
DN200	DN150	mm	150	490	-	190	397.20	510.00	-	-	360	35.92	35.92	46.50	2"-8	40.00 (F14)	140.00	M16X20	148.0	1552
8"	6"	inch	5.91	19.29	-	7.48	15.64	20.08	-	-	14.17	1.41	1.41	1.83	UN-2A	1.57	5.51	M16X20	325.6	1800
	DN200	mm	200	500	-	275	499.00	654.00	-	-	470	45.90	45.90	55.00	2¾"-8	50.00 (F16)	165.00	M20x30	380.0	1552
	8"	inch	7.87	19.69	-	10.83	19.65	25.75	-	-	18.50	1.81	1.81	2.17	UN-2A	1.97	6.50	M20x30	836.0	1800

**Z47T****Z47M**

2½"-8" | DN65-DN200 | CLASS 600



Floating Ball 3 Piece Up to **T** 538°C (1000°F) | **M** 650°C (1200°F)

### Components & materials

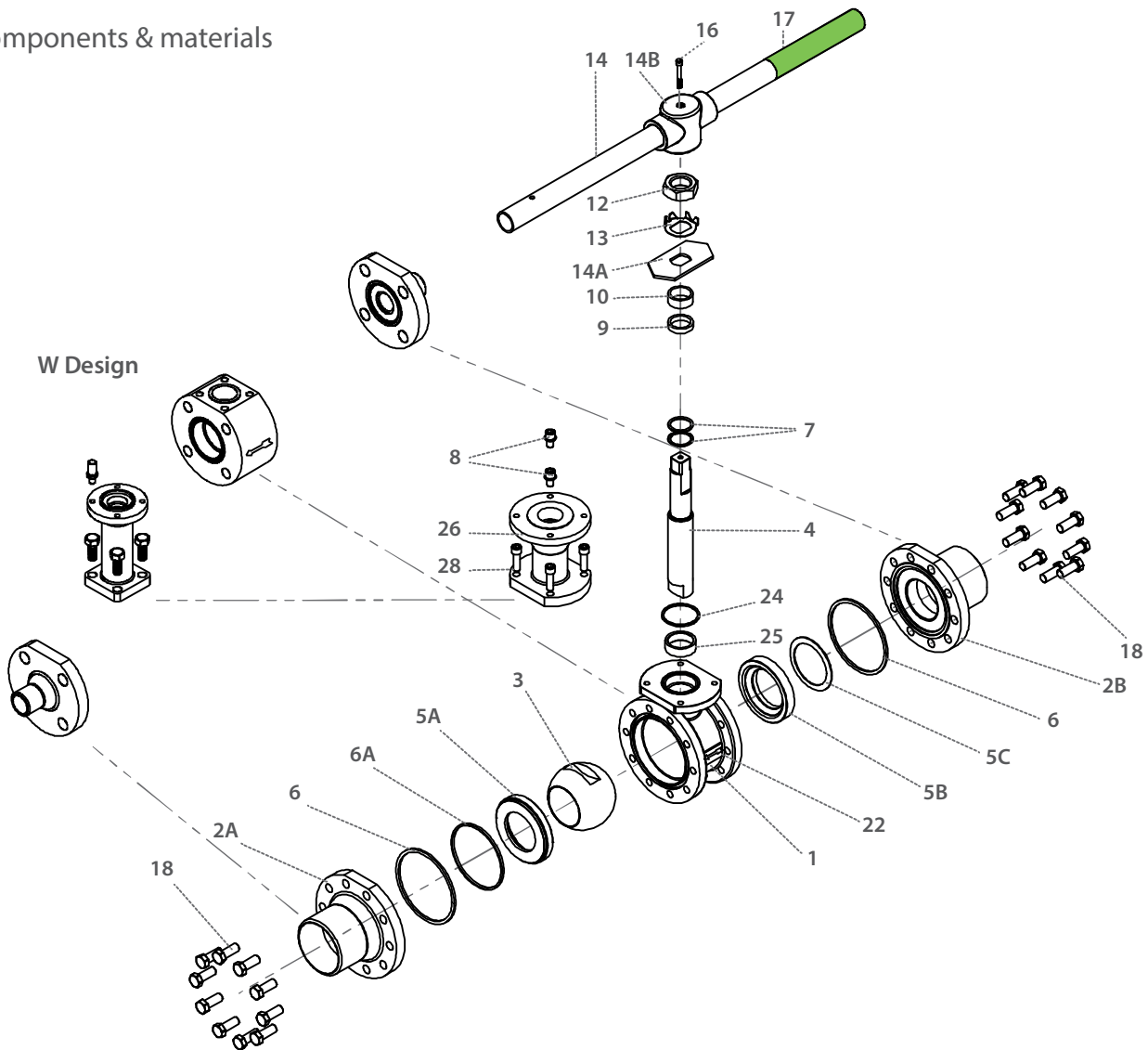

Item	Description	Material specification	Qty.
1	Body	Acc. Ordering Code	1
2A	Downstream end	Acc. Ordering Code	1
2B	Upstream end	Acc. Ordering Code	1
3	Ball	Acc. Ordering Code	1
4	Stem	Acc. Ordering Code	1
5A	Downstream seat	Acc. Ordering Code	1
5B	Upstream seat	Acc. Ordering Code	1
5C	Upstream seat spring	Inconel 718	1
6*	Body seal	Graphite	2
6B*	Seat seal	Graphite	1
7*	Stem thrust seal	A479 316L, Hardened with LTPN, B637 N07718 Inconel 718	2
8	Stop pin	S. Steel	1
9*	Stem seal	Graphite	1
10	Follower	S. Steel	1
11	Disc spring	S. Steel	2

Item	Description	Material specification	Qty.
12	Stem nut	S. Steel	1
13	Tab lock washer	S. Steel	1
14**	Handle	S. Steel	1
14A	Stop plate	S. Steel	1
14B	Wrench head	S. Steel	1
16	Wrench bolt	S. Steel	1
17	Sleeve	PVC	1
18	Body bolts	S. Steel	20-32
22	Arrowseal	S. Steel	1
23	Tag (not shown)	S. Steel	1
24	Bonnet seal	S. Steel	1
25	Stem Bearing	S. Steel	1
26	Bonnet	S. Steel	1
28	Bonnet bolts	S. Steel	4-6

\* Repair kit components

\*\* Gear operator should be used for size 4" DN100 and above (handle components are not included)