

FIRE TEST QUALIFICATION CERTIFICATE

DCI Meettechniek B.V.
Stationsstraat 51
Postbus 86
NL-4420 AC Kapelle
Tel. (0113) 344110
Fax (0113) 344100

Item	Ball Valve
Size	1½" (DN40)
Class	1500 psi (600 lbs)
Serial No.	no data
Body material	CF8M
Seat material	NRG
Manufactured by	Habonim Industrial Valves & Actuators Ltd
In accordance with job no.	2009445
In accordance with drawing no.	not applicable

The above valve was tested by DCI Meettechniek BV at their valve testing facilities in Kapelle, the Netherlands and the results have been recorded as PASS, having complied with the minimum performance requirements stated in specification:

ANSI/API Standard 607 Fifth Edition, June 2005
&
ISO 10497-5:2004 (Identical), Testing of valves
Fire type-testing requirements

Test date	June 10 th 2008
Other sizes qualified	1½" and below; 2", 2½", 3"
Other pressure ranges qualified	600, 800, 900, PN100 and PN150

Tested by:



J-P Nijsten

J-P Nijsten (DCI)
Date: 10/06/2008

Witnessed by:



P. Delau (TUV)

Date: 10/06/2008

This certificate must be read in conjunction with the full DCI Meettechniek BV test report number:

84181-R002



Material specification of tested valve

CRYOGENIC VALVES

**1/2"-2" C47C
Material Specification**

Item	Description	Material Specification	Qty.
1	Body	SS316L	1
2	End connecty	SS316L	2
3	Ball	SS316L	1
4	Stem	SS316L	1
5	Seat	SS316L	2
6	Body seal	PTFE	2
7	Stem thrust seal	NBR	1
8	Stem packing	Monel	1
9	Follower	SS316L	1
10	Disc spring	SS316L	2
11	Stem nut	SS316L	1
12	Locking disk	SS316L	1
13	Handle	SS316L	1
14	Handle washer	SS316L	1
15	Handle nut	SS316L	1
16	Stem	SS316L	1
17	Disc pin	SS316L	1
18	Stem seal	PTFE	1
19	Stem bearing	PTFE	1
20	Body bolt	SS316L	2
21	Spring washer	SS316L	2
22	Bottom lock	SS316L	2
23	Spring washer	SS316L	2
24	Bottom	SS316L	1
25	Anti static spring	SS316L	1
26	Anti static ball	SS316L	1
27	Flow arrow	SS316L	2

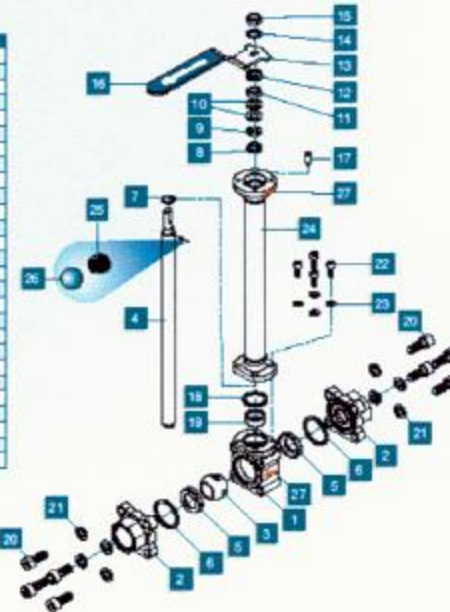

Valve Dimensions

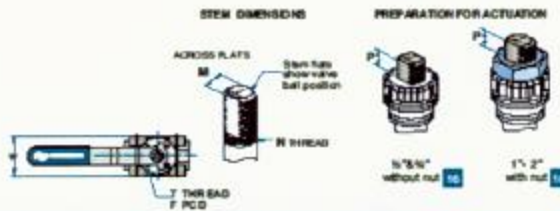
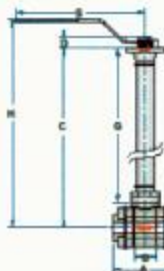

Size	Flange	Body	A	B	C	D	H	G	S	W	T	F	M	N	P	Weight (kg)
3/4"	1/2"	1.18	66	20.8	22.2	8.2	266	24	160	48	16	36	6.8	3/8" LNF	7.2	1.6
1"	3/4"	1.45	71	24.5	25.5	8.5	285	24	175	50	16	36	6.8	3/8" LNF	7.2	1.8
1 1/4"	1"	2.08	84	31.7	34.2	12.5	350	30.4	202	60.8	16	42	7.54	7/16" LNF	7.2	3
1 1/2"	1 1/4"	2.30	88	33.8	36.2	12.5	360	30.4	202	60.8	16	42	7.54	7/16" LNF	7.2	3.2
1 3/4"	1 1/2"	2.55	92	35.8	38.2	12.5	370	30.4	202	60.8	16	42	7.54	7/16" LNF	7.2	3.4
2"	1 3/4"	2.80	96	37.8	40.2	12.5	380	30.4	202	60.8	16	42	7.54	7/16" LNF	7.2	3.6
2 1/4"	2"	3.05	100	39.8	42.2	12.5	390	30.4	202	60.8	16	42	7.54	7/16" LNF	7.2	3.8
2 3/4"	2 1/4"	3.30	104	41.8	44.2	12.5	400	30.4	202	60.8	16	42	7.54	7/16" LNF	7.2	4.0
3"	2 3/4"	3.55	108	43.8	46.2	12.5	410	30.4	202	60.8	16	42	7.54	7/16" LNF	7.2	4.2
3 1/4"	3"	3.80	112	45.8	48.2	12.5	420	30.4	202	60.8	16	42	7.54	7/16" LNF	7.2	4.4
3 1/2"	3 1/4"	4.05	116	47.8	50.2	12.5	430	30.4	202	60.8	16	42	7.54	7/16" LNF	7.2	4.6
3 3/4"	3 1/2"	4.30	120	49.8	52.2	12.5	440	30.4	202	60.8	16	42	7.54	7/16" LNF	7.2	4.8
4"	3 3/4"	4.55	124	51.8	54.2	12.5	450	30.4	202	60.8	16	42	7.54	7/16" LNF	7.2	5.0
4 1/4"	4"	4.80	128	53.8	56.2	12.5	460	30.4	202	60.8	16	42	7.54	7/16" LNF	7.2	5.2
4 1/2"	4 1/4"	5.05	132	55.8	58.2	12.5	470	30.4	202	60.8	16	42	7.54	7/16" LNF	7.2	5.4

agreed DCI

J-P Nijsten
DCI
meettechniek

name
J-P Nijsten
date
10-06-2008

agreed client

name
date

agreed authority

TUV SUD Industrie Service GmbH
TUV SUD
P. Deleu
name
P. Deleu
date
10-06-2008